

# Eye & Eye Rigging Screws

## Product Description

- AS2319-2001
- 6:1 Safety Factor
- Grades L, P & S
- Fully Tested and Certified to AS2319
- Galvanized
- Manufactured using only heat certified Australian Steel (AS1442/AS1444)



### Available on Request

- Lock Nuts

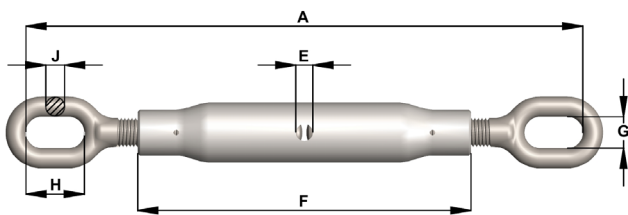

Townley Drop Forge is both NATA Accredited (Test Lab No. 13554) and AS/NZS ISO9001 Certified (Certificate number FS 604897)..

### Dimensions and Working Load Limits (WLL) Metric - Grades L , P & S

Nominal Size	A Closed	A Open	E	F	G	H	J	Grade L WLL	Grade P WLL	Grade S WLL
M10	260	380	8.5	180	12	21	7	0.3t	0.6t	0.8t
M12	340	520	8.5	230	15	30	9	0.5t	1t	1.2t
M16	350	525	9.0	230	17	36	12	0.75t	1.6t	2t
M20	380	545	10.5	230	21	42	12	1.25t	2.5t	3.2t
M24	540	725	13.0	360	25	51	17	2.5t	4t	5t
M33	660	936	14.0	380	33	70	24	5t	8t	10t
M48	750	1000	18.0	420	44	91	38	N/A	16t	20t

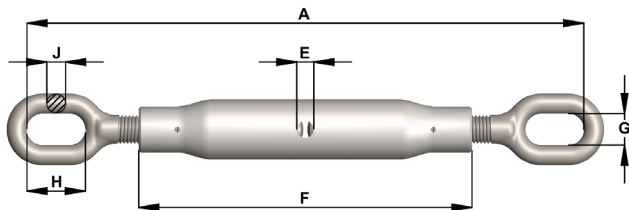

### Dimensions and Working Load Limits (WLL) BSW – Grade L

Nominal Size	A Closed	A Open	E	F	G	H	J	Grade L WLL
1 1/4"	590	837	14	380	35	65	22	5t
1 1/2"	648	927	16	405	38	75	25	6t
1 3/4"	686	946	17	405	41	88	32	7.5t
2"	717	965	19	405	44	102	38	10t
2 1/4"	813	1016	22	405	60	130	41	15t
2 1/2"	813	1016	22	405	60	130	47	20t

Subject to technical modifications